

## ALUMINUM COUPLINGS

Reusable aluminum coupling system, suitable to be fitted to MARMOTECH® and STEELBLAST hoses, including:

- Aluminum semi-flanges according to UNI EN 1092-1 PN 10 (ex UNI 2277)
- Flat black SBR gasket
- Bolts, nuts and washers for the semi-flanges connection

Easy to handle and to install: special tools and trained personnel staff are not required.

Designed with self-blocking domed cup nuts to facilitate the semi-flanges connection.

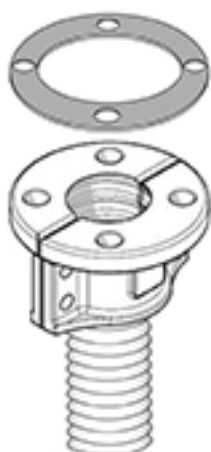

Nominal Size		Couplings dimensions							Nipple length		Appr. weight	
		Holes number	Holes diameter		Bolt circle		Outside flange diameter					
[mm]	[in]		[mm]	[in]	[mm]	[in]	[mm]	[in]	[mm]	[in]	[kg]	[lbs]
40	1,50	4	18	0,71	110	4,33	150	5,91	86	3,39	1,3	2,9
50	2,00	4	18	0,71	125	4,92	165	6,50	86	3,39	1,6	3,5
80	3,00	8	18	0,71	160	6,30	200	7,87	88	3,46	2,1	4,6
100	4,00	8	18	0,71	180	7,09	220	8,66	105	4,13	2,8	6,2
125	5,00	8	18	0,71	210	8,27	250	9,84	110	4,33	3,6	7,9
150	6,00	8	22	0,87	240	9,45	285	11,22	120	4,72	4,8	10,6
200	8,00	8	22	0,87	295	11,61	340	13,39	155	6,10	7,8	17,2
250	10,00	12	22	0,87	350	13,78	395	15,55	175	6,89	9,5	20,9
300	12,00	12	22	0,87	400	15,75	445	17,52	200	7,87	14	30,9
350	14,00	16	22	0,87	460	18,11	505	19,88	210	8,27	17	37,5
400	16,00	16	26	1,02	515	20,28	565	22,24	220	8,66	22	48,5